



Below Deck Fuel Tanks

Ideal For Use With Either Diesel or Gasoline Fuels

Instructions for installation of fuel tanks

A qualified dealer should perform the installation and system check if you are unfamiliar with current regulations.

OBSERVE ALL NOTES, CAUTIONS AND SAFETY WARNINGS CONTAINED IN THIS MANUAL. IT IS TO YOUR ADVANTAGE TO DO SO TO PROTECT YOUR AND YOUR INVESTMENT.

THE PURPOSE OF THE SAFETY SYMBOLS IS TO ATTRACT YOUR ATTENTION TO POSSIBLE DANGERS. THE SYMBOLS, AND THE EXPLANATIONS WITH THEM, DESERVE YOUR CAREFUL ATTENTION AND UNDERSTANDING. SAFETY WARNINGS DO NOT, BY THEMSELVES, ELIMINATE ANY DANGER. THE INSTRUCTIONS OR WARNINGS THEY GIVE ARE NOT SUBSTITUTES FOR PROPER ACCIDENT PREVENTION MEASURES.

⚠WARNING

FAILURE TO OBEY SAFETY WARNINGS MAY RESULT IN INJURY TO YOU OR OTHERS.

FUEL IS EXTREMELY FLAMMABLE.

Operation:

Most fuel associated accidents occur either during or shortly following fueling; therefore, special precautions should be taken.

When taking on fuel, be sure that all open flames are extinguished.

Operate the bilge blower for at least 5 minutes before starting and keep blower on during starting and when operating boat below cruising speed.

If boat is not equipped with a power bilge blower, open all hatches needed to assure natural ventilation. Gasoline fumes are heavier than air.

Important:

Read all information contained, thoroughly, before installing or using fuel tank.

1. In view of the possible hazards associated with leaking fuel, continuous inspection and maintenance of your fuel system is recommended.
2. Before installing your fuel tank, read "TANK INSTALLATION RECOMMENDATIONS" thoroughly.
3. Do not "foam in" your fuel tank! An installed tank should be ventilated on all sides.
4. The use of an inline fuel filter is recommended. Contact your Tempo dealer.
5. For a diesel fuel return kit, contact your Tempo Dealer.
6. Do not pry upward on your withdrawal head. It is not removeable.

Tank Inspection

Your Tempo Fuel Tank has been manufactured to the current standards as set forth by the American Boat & Yacht Council (ABYC). After manufacture, the tank is subjected to factory testing and inspection.

Tempo Tanks meet the requirements of 33 CFR 183.510. This standard mandates pressure checks to 3 psi of the entire fuel system. Example: tank fill, vent, electric sending unit.

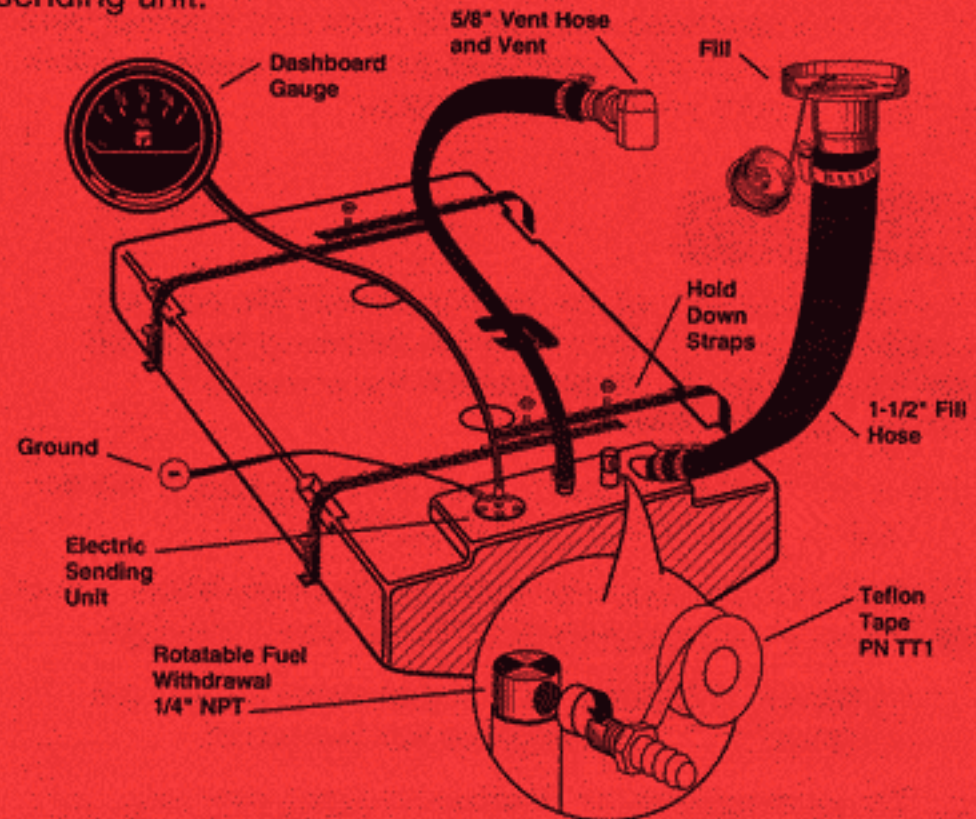

Figure 1

Tank Installation Recommendations

⚠WARNING

FAILURE TO OBEY SAFETY WARNINGS MAY RESULT IN INJURY TO YOU OR OTHERS.

FUEL IS EXTREMELY FLAMMABLE.

1. All fuel tanks should be installed in a location where they can be easily inspected and/or removed and will not be reached by normal accumulations of water.
2. An installed tank should be ventilated on all sides.
3. Tanks shall be secured to prevent movement. Special Tempo hold down clamps and/or cradles are available for this purpose. **NOTE: All plastic tanks expand slightly in all directions when filled with fuel.** Due to this expansion it is important that the tank is allowed to expand approximately 3% in all directions and not be confined. The use of Tempo's specially designed hold downs are recommended to allow for the expansion.

- After installation, and before filling tank with fuel, the entire fuel system (from the deck fill to the engine, including the fuel tank) **shall** be pressure tested to 3 psi. It is recommended this pressure be maintained for a minimum of 5 minutes. (refer to Figure 1.)
- All permanently installed fuel tanks must be grounded. For grounding purposes, electrical continuity must be maintained between fill plate on deck and the engine, except outboards where grounding can be to a special ground on the boat. Special grounding devices are available – Tempo Part #117TGD for plastic tanks – if not already installed on the boat. They generally extend through the non-metallic holes to below the water line.

Annual Inspection

- Most of today's gasoline contains alcohol. Inspection of all fuel hoses, gaskets on fuel tanks and the fuel tank itself should be checked at least annually.
- Fill and vent lines, the deck fill plate and thru hull vent fitting, should be installed so that overflow of gasoline or its vapors will not re-enter boat.

CAUTION

Momentary contact of the ignition wire to the sending terminal or ground terminal of the receiving gauge will damage this gauge. Make certain the power is OFF before connecting your wires.

Due to residual magnetism, your receiving gauge will not go back to empty when it is turned off.

Most problems are due to improper grounds. Make certain all of your grounding connections are clean and tight.

When taking on fuel, be sure that all open flames are extinguished and motor/engines are turned off.

- Terminal location on receiving gauges may vary. Tempo's sending unit is compatible to 33-240 OHMS. (Figure 2)

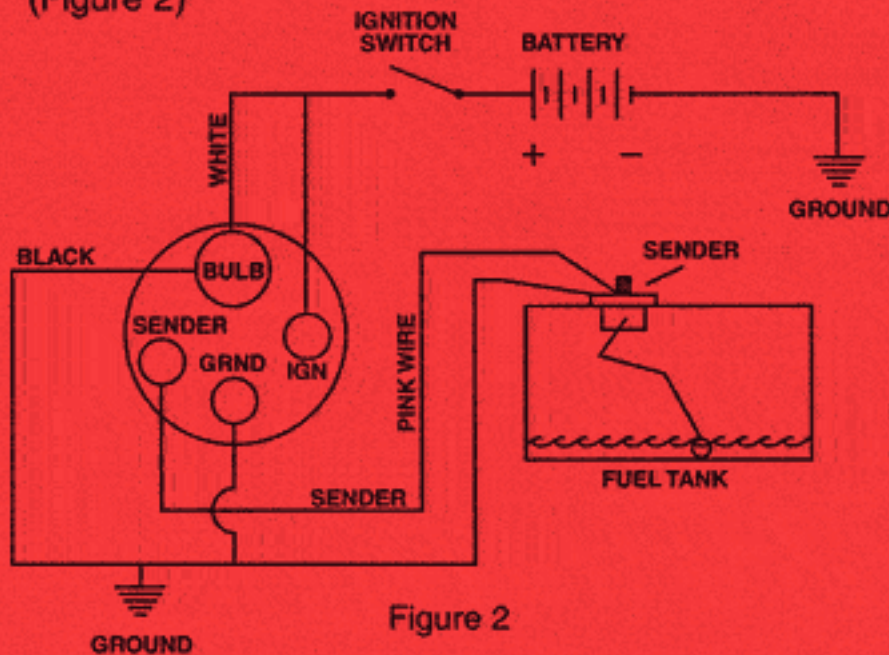

Figure 2

Care and Maintenance

WARNING

FAILURE TO OBEY SAFETY WARNINGS MAY RESULT IN INJURY TO YOU OR OTHERS.

- Inspect fuel system at least annually, including all fuel and grounding components. **Experienced boaters have found it a safe practice to inspect fuel system before each use.**
- As most gasolines contain alcohol, and alcohol absorbs moisture (water), the use of Tempo #K100 is recommended. K100 is specially formulated for marine use to absorb this moisture and enhance the octane.
- Check hoses and hose clamps at least annually. Tighten hose clamps if necessary. Replace hoses annually.

After replacement of any fuel system component, pressure check entire system, including tank, hose, gaskets, screw connections, as in a new installation. (See "TANK INSTALLATION RECOMMENDATIONS")

- Fuel level unit has been factory assembled and tested. Extreme caution should be taken in making any repairs or replacements. Always use a new gasket and recheck system for pressure retention. (See "TANK INSTALLATION RECOMMENDATIONS")

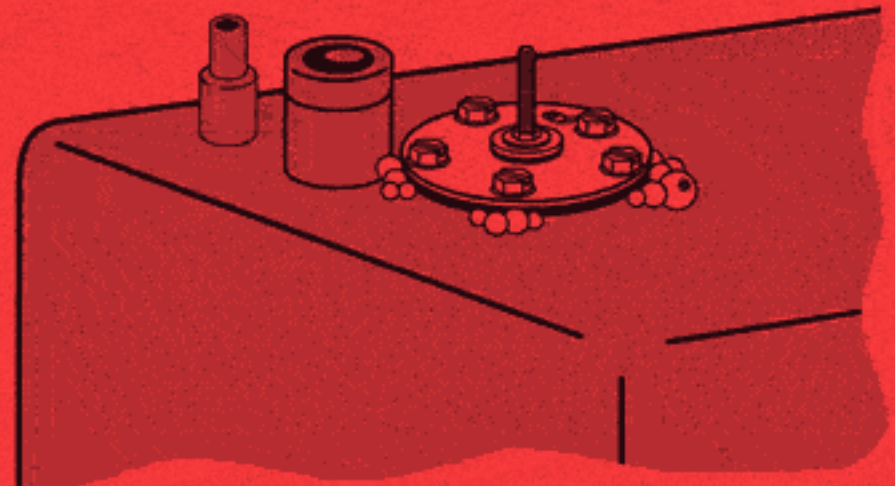

Figure 3

For further information on our complete line of TEMPO Fuel System Accessories, please complete and return the enclosed card with your name and address as shown.